

AGRICULTURAL PARTS

12 SERIES

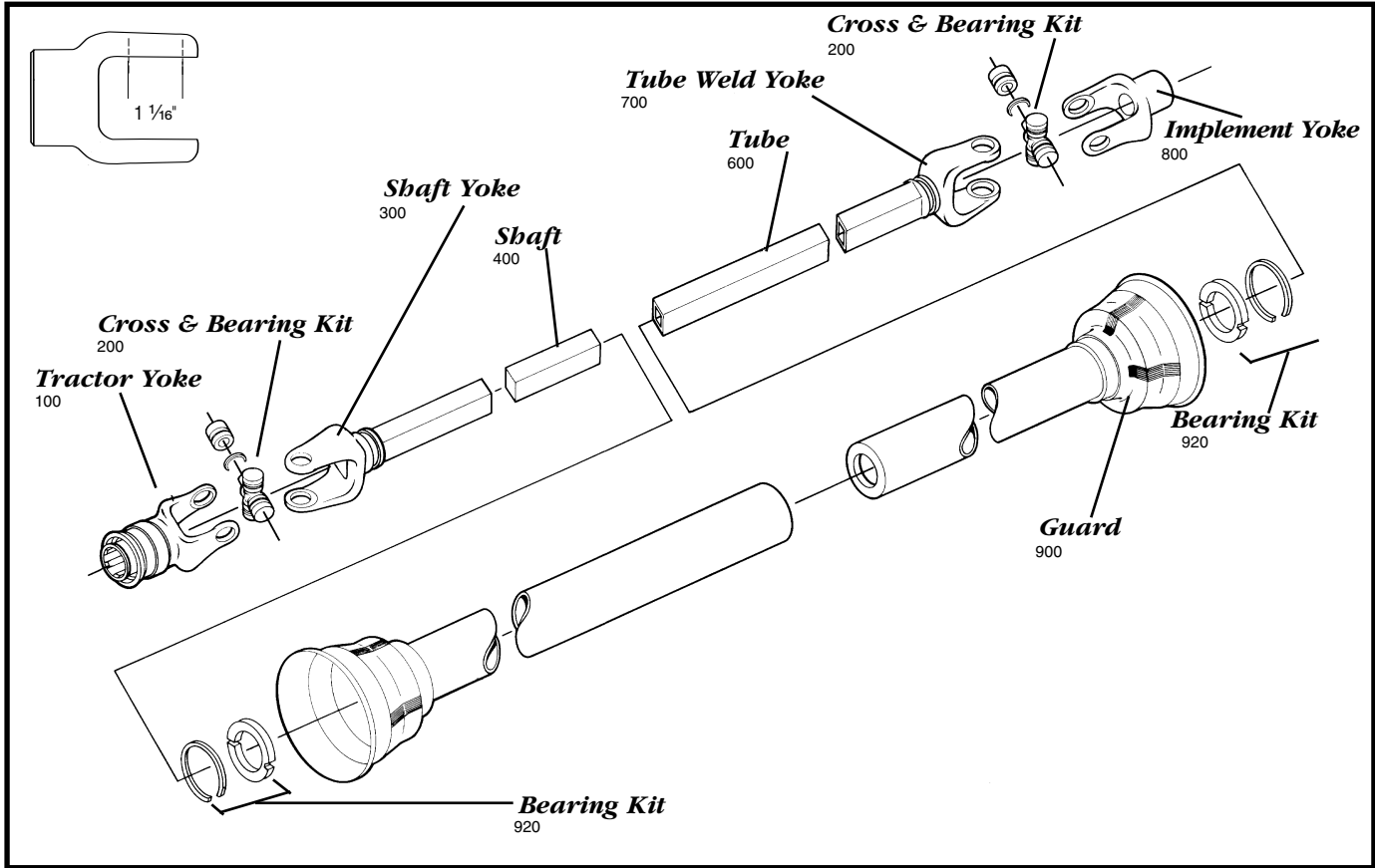

Tractor Yoke

Spring-Lok
(COLLAR TYPE)

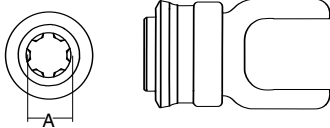

SPECIFICATIONS

RB&H #	REFERENCE #	DIM. "A" BORE (IN.)
100-1206	12R220-20-SL	1 3/8 x 6
100-1221	12R220-TQD-SL	1 3/8 x 21

Ball Shear Device

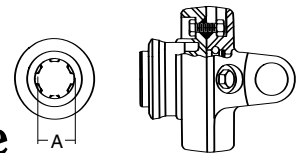

SPECIFICATIONS

RB&H #	REFERENCE #	DIM. "A" BORE (IN.)	SHEAR BOLT (IN.)
104-1206	12R220-20-BS	1 3/8 x 6	5/16 -18 Gr. 5
104-1221	12R220-TQD-BS	1 3/8 x 21	5/16 -18 Gr. 5

With Spring-Lok

Quick Disconnect

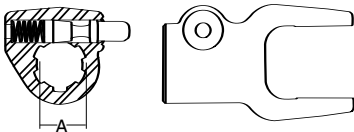

SPECIFICATIONS

RB&H #	REFERENCE #	DIM. "A" BORE (IN.)
102-1206	12R220-20	1 3/8 x 6
102-1221	12R220-TQD	1 3/8 x 21

Cross & Bearing Kit

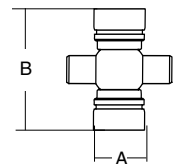

SPECIFICATIONS

RB&H #	NEAPCO #	REFERENCE #	DIM. "A" BORE (IN.)	DIM. "B" BORE (IN.)
200-1200	1-1275	12R	1 1/16	2 9/16
201-1200		Extended Life	1 1/16	2 9/16

Snap ring located in bushing

AGRICULTURAL PARTS

12 SERIES

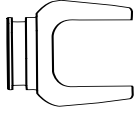
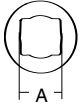

Shaft Weld Yoke

SPECIFICATIONS

RB&H #	REFERENCE #	DIM. "A" BORE (IN.)
300-1200	12RWY1618	1 x 1 1/8

With bearing groove



Shaft

1" x 1 1/8" RECTANGULAR

SPECIFICATIONS

RB&H #	REFERENCE #	LENGTH (FT.)
400-1618	B1200	6

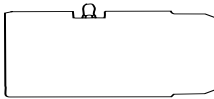
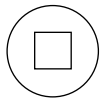

Slip Sleeve

1" x 1 1/8" RECTANGULAR

SPECIFICATIONS

RB&H #	REFERENCE #	LENGTH (IN.)	FITS TUBE SIZE (IN.)
500-1400	12-14RS06	5	2 (.083 Wall)

With grease groove



Tube

1 1/4" x 1 7/8" RECTANGULAR O.D.

SPECIFICATIONS

RB&H #	REFERENCE #	LENGTH (FT.)	FITS SHAFT (IN.)
600-2022	A1200	6	1 x 1 1/8

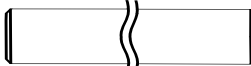

2" (.083 WALL)

SPECIFICATIONS

RB&H #	REFERENCE #	LENGTH (FT.)
602-1400	14RTT	6

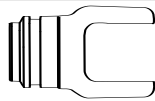

Tube Weld Yoke

SPECIFICATIONS

RB&H #	REFERENCE #	DIM. "A" BORE (IN.)	FITS TUBE SIZE "B" (IN.)
700-1200	12RWY2022	1 1/4 x 1 3/8	-
701-1200	12RWY1834	-	2 (.083 Wall)

With bearing groove

Implement Yokes

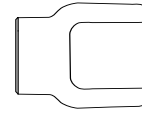
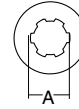

Spline Bore

SPECIFICATIONS

RB&H #	REFERENCE #	DIM. "A" BORE (IN.)
801-1206	12R220-21	1 3/8 x 6
801-1218	12R180-21	1 1/8 x 6
801-1221	12R220-T	1 3/8 x 21

With 2 1/4" pin hole

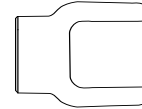

Shear Pin

SPECIFICATIONS

RB&H #	REFERENCE #	DIM. "A" BORE (IN.)
802-1216	12R160-7	1
802-1218	12R180-7	1 1/8
802-1220	12R200-7	1 1/4
802-1222	12R220-7	1 3/8

With 1/4" pin hole

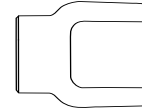
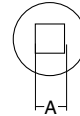

Square Bore

SPECIFICATIONS

RB&H #	REFERENCE #	DIM. "A" BORE (IN.)
804-1214	12R140-26	7/8
804-1216	12R160-26	1
804-1218	12R180-26	1 1/8
804-1220	12R200-26	1 1/4

With set screw

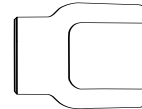
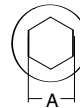

Hexagon Bore

SPECIFICATIONS

RB&H #	REFERENCE #	DIM. "A" BORE (IN.)
805-1218	12R180-H	1 1/8

With set screw

AGRICULTURAL PARTS

12 SERIES

Round Bore

WITH KEYWAY
& SET SCREW

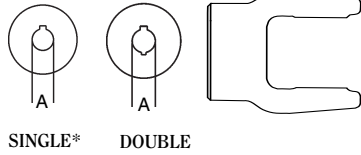

Yoke & Shaft Assembly

1" x 1 1/8" SHAFT

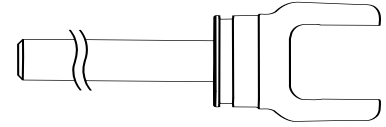

SPECIFICATIONS

RB&H #	BORE (IN.)	KEYWAY (IN.)
800-1212*	3/4	3/16
800-1214*	7/8	3/16
800-1215*	15/16	1/4
806-1216	1	1/4 & 3/16
806-1218	1 1/8	1/4 & 5/16
800-1219*	1 3/16	1/4
806-1220	1 1/4	1/4 & 15/16
800-1222*	1 3/8	15/16
800-1224*	1 1/2	3/8

SPECIFICATIONS

RB&H #	REFERENCE #	OVERALL DRIVELINE LENGTH (IN.)
10001248	12R48M	48

Yoke & Tube Assembly

1 1/4" x 1 3/8" TUBE

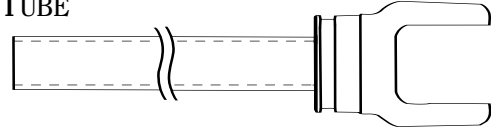

SPECIFICATIONS

RB&H #	REFERENCE #	FITS SHAFT (IN.)	OVERALL DRIVELINE LENGTH (IN.)
11001248	12R48F	1 x 1 1/8	48

Guard

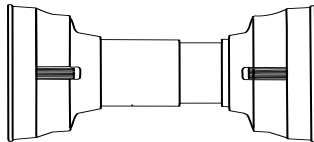

Plastic Guard

SPECIFICATIONS

RB&H #	OVERALL DRIVELINE LENGTH (IN.)
900-2548	48
900-2560	60

With bearings (921-1200)

NOTE: When installing guards observe the following:

- 1) Install proper nylon bearing and retainer
- 2) Check to insure guards turn freely on bearing