

BRASS FITTINGS

PIPE

Pipe

PRESSURE: Up to 1,200 psi operating.
 USED WITH: Brass or iron pipe.
 TEMPERATURE: -65°F to 250°F.

Allen Head

Plug

(HEX SOCKET)

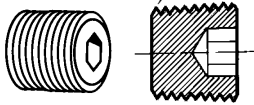

SPECIFICATIONS

RB&H #	REFERENCE #	MALE PIPE (IN.)
117ALX2	3153X2	1/8
117ALX4	3153X4	1/4
117ALX6	3153X6	3/8
117ALX8	3153X8	1/2

Cap

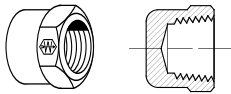

SPECIFICATIONS

RB&H #	PIPE THREAD (IN.)
3129X2	1/8
3129X4	1/4
3129X6	3/8
3129X8	1/2

Slotted Plug

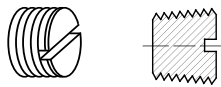

SPECIFICATIONS

RB&H #	PIPE THREAD (IN.)
3150X2	1/8
3150X4	1/4
3150X6	3/8

Square Head Plug

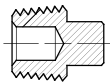

SPECIFICATIONS

RB&H #	MALE PIPE (IN.)
3151X2	1/8
3151X4	1/4
3151X6	3/8
3151X8	1/2
3151X12	3/4

Hex Head Plug



SPECIFICATIONS

RB&H #	MALE PIPE (IN.)
3152X2	1/8
3152X4	1/4
3152X6	3/8
3152X8	1/2
3152X12	3/4

Cross

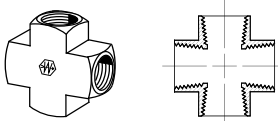

SPECIFICATIONS

RB&H #	FEMALE PIPE (IN.)
3950X4	1/4
3950X6	3/8
3950X8	1/2
3950X12	3/4
3950X12/C	3/4

Adapter

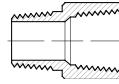

SPECIFICATIONS

RB&H #	MALE PIPE (IN.)	FEMALE PIPE (IN.)
3200X2	1/8	1/8
3200X4	1/4	1/4
3200X6	3/8	3/8
3200X8	1/2	1/2
3200X4X2	1/8	1/4
3200X6X2	1/8	3/8
3200X6X4	1/4	3/8
3200X8X6	3/8	1/2
3200X12X8	1/2	3/4

Bushing

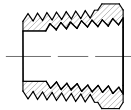

SPECIFICATIONS

RB&H #	MALE PIPE (IN.)	FEMALE PIPE (IN.)
3220X4X2	1/4	1/8
3220X6X2	3/8	1/8
3220X6X4	3/8	1/4
3220X8X2	1/2	1/8
3220X8X4	1/2	1/4
3220X8X6	1/2	3/8
3220X12X2	3/4	1/8
3220X12X4	3/4	1/4
3220X12X6	3/4	3/8
3220X12X8	3/4	1/2
3220X16X6	1	3/8
3220X16X8	1	1/2
3220X16X12	1	3/4

Union

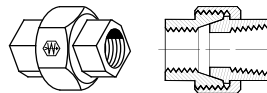

SPECIFICATIONS

RB&H #	FEMALE PIPE (IN.)
3250X2	1/8
3250X4	1/4
3250X6	3/8
3250X8	1/2

Coupling

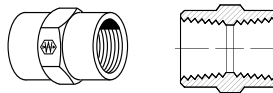

SPECIFICATIONS

RB&H #	FEMALE PIPE (IN.)
3300X2	1/8
3300X4	1/4
3300X6	3/8
3300X8	1/2
3300X12	3/4

Reducer Coupling

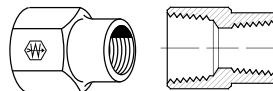

SPECIFICATIONS

RB&H #	FEMALE (1) PIPE (IN.)	FEMALE (2) PIPE (IN.)
3300X4X2	1/4	1/8
3300X6X2	3/8	1/8
3300X6X4	3/8	1/4
3300X8X4	1/2	3/4
3300X8X6	1/2	3/8
3300X12X8	3/4	1/2

BRASS FITTINGS

PIPE

SPECIFICATIONS		
RB&H #	PIPE (1) THREAD (IN.)	PIPE (2) THREAD (IN.)
3325X2	1/8	1/8
3325X4	1/4	1/4
3325X4X2	1/4	1/8
3325X6	3/8	3/8
3325X6X2	3/8	1/8
3325X6X4	3/8	1/4
3325X8X4	1/2	1/4
3325X8X6	1/2	3/8
3325X8	1/2	1/2
3325X12X8	3/4	1/2
3325X12	3/4	3/4

Hex Nipple

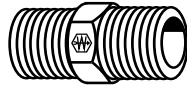

SPECIFICATIONS		
RB&H #	PIPE THREAD (IN.)	FEMALE PIPE (IN.)
3350X2	1/8	1/8
3350X4	1/4	1/4
3350X6	3/8	3/8
3350X8	1/2	1/2
3350X12	3/4	3/4

(45°) Street Elbow

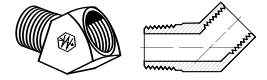

SPECIFICATIONS	
RB&H #	PIPE THREAD (IN.)
3326X2	1/8
3326X4	1/4
3326X6	3/8
3326X8	1/2
3326X12	3/4

Close Nipple

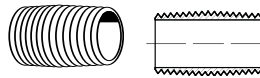

SPECIFICATIONS		
RB&H #	FEMALE PIPE (IN.)	MALE PIPE (IN.)
3400X2	1/8	1/8
3400X4X2	1/4	1/8
3400X4	1/4	1/4
3400X6	3/8	3/8
3400X8	1/2	1/2
3400X12	3/4	3/4

Street Elbow

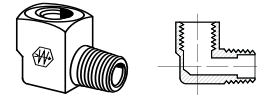

SPECIFICATIONS		
RB&H #	PIPE THREAD (IN.)	LENGTH (IN.)
3327X2	1/8	1 1/2
3328X2	1/8	2
3329X2	1/8	2 1/2
3330X2	1/8	3
3332X2	1/8	4
3334X2	1/8	6
3327X4	1/4	1 1/2
3328X4	1/4	2
3329X4	1/4	2 1/2
3330X4	1/4	3
3331X4	1/4	3 1/2
3332X4	1/4	4
3334X4	1/4	6
3327X6	3/8	1 1/2
3328X6	3/8	2
3329X6	3/8	2 1/2
3330X6	3/8	3
3332X6	3/8	4
3334X6	3/8	6
3327X8	1/2	1 1/2
3328X8	1/2	2
3329X8	1/2	2 1/2
3330X8	1/2	3
3331X8	1/2	3 1/2
3332X8	1/2	4
3334X8	1/2	6
3328X12	3/4	2
3329X12	3/4	2 1/2
3330X12	3/4	3
3332X12	3/4	4

Long Nipple

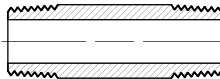
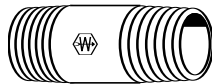

SPECIFICATIONS	
RB&H #	FEMALE PIPE (IN.)
3500X2	1/8
3500X4	1/4
3500X6	3/8
3500X8	1/2
3500X12	3/4

Elbow

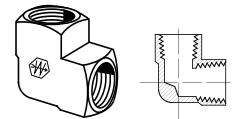

SPECIFICATIONS		
RB&H #	MALE PIPE (IN.)	FEMALE PIPE (IN.)
3600X2	1/8	1/8
3600X4	1/4	1/4
3600X6	3/8	3/8
3600X8	1/2	1/2
3600X12	3/4	3/4

Male Branch Tee

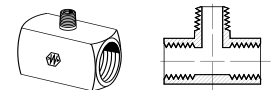

SPECIFICATIONS	
RB&H #	FEMALE PIPE (IN.)
3700X2	1/8
3700X4	1/4
3700X6	3/8
3700X8	1/2
3700X12	3/4

Tee

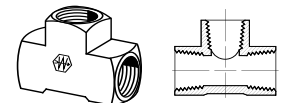

SPECIFICATIONS		
RB&H #	MALE PIPE (IN.)	FEMALE PIPE (IN.)
3750X2	1/8	1/8
3750X4	1/4	1/4
3750X6	3/8	3/8
3750X8	1/2	1/2

Street Tee (MALE RUN TEE)

