

HYDRAULIC QUICK DISCONNECTS

COUPLERS & PLUGS

HK Series - 2 Way
1HK to 8 HK
1/8" to 1" Body



Series HK Couplings are designed for general purpose hydraulic service. Some are suitable for use with various liquids, chemicals, steam, gases, and vacuum. Series HK couplings conform to the dimensional requirements of ISO 7241-1 Series B.

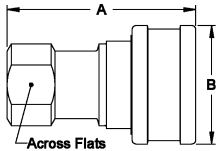

FEATURES

- Brass, steel and stainless steel construction available in all sizes.
- End connections are female NPTF, BSPP and SAE o-ring boss.
- Heavy duty steel couplings for use in high impulse service available in most size.
- Steam coupling available in 3/8" body size.

STANDARD MATERIALS

- Brass, zinc-plated steel, stainless steel.
- Stainless steel springs, balls and retaining rings.
- Buna-N (Nitrile) seals.
- Teflon back-up rings in 1-HK through 8-HK steel and stainless steel sockets.

OPTIONS

- Non-valved socket and plug.
- Valve actuator in socket or plug.
- Bleeder-style plug.
- Sleeve lock.
- Seals: Teflon, Neoprene, Viton, Buna-N, EPDM and Kalrez.

ACCESSORIES

- Dust caps and dust plugs.

SOCKET SPECIFICATIONS

BODY SIZE (IN.)	PRODUCT I.D.			THREAD SIZE FEMALE NPTF	"A" (IN.)	"B" (IN.)	"ACROSS FLATS" (IN.)
	BRASS STANDARD RB&H#	STEEL STANDARD RB&H#	STAINLESS STEEL 303 RB&H#				
1/8	BH1-60/PH	H1-62/PH	SH1-62/PH	1/8 - 27	1.91	0.98	0.56
1/4	BH2-60/PH	H2-62/PH	SH2-62/PH	1/4 - 18	2.26	1.17	0.75
3/8	BH3-60/PH	H3-62/PH	SH3-62/PH	3/8 - 18	2.56	1.42	0.88
1/2	BH4-60/PH	H4-62/PH	SH4-62/PH	1/2 - 14	2.96	1.86	1.13
3/4	BH6-60/PH	H6-62/PH	SH6-62/PH	3/4 - 14	3.48	2.22	1.31
1	BH8-60/PH	H8-62/PH	SH8-62/PH	1 - 11 1/2	4.13	2.61	1.75

PLUG SPECIFICATIONS

BODY SIZE (IN.)	PRODUCT I.D.			THREAD SIZE FEMALE NPTF	"C" (IN.)	"D" (IN.)	"E" (IN.)	"HEX" (IN.)
	BRASS STANDARD RB&H#	STEEL STANDARD RB&H#	STAINLESS STEEL 303 RB&H#					
1/8	BH1-61/PH	H1-63/PH	SH1-63/PH	1/8 - 27	1.26	0.65	0.44	0.56
1/4	BH2-61/PH	H2-63/PH*	SH2-63/PH	1/4 - 18	1.52	0.87	0.56	0.75
3/8	BH3-61/PH	H3-63/PH	SH3-63/PH	3/8 - 18	1.76	1.01	0.61	0.88
1/2	BH4-61/PH	H4-63/PH	SH4-63/PH	1/2 - 14	2.03	1.30	0.76	1.13
3/4	BH6-61/PH	H6-63/PH	SH6-63/PH	3/4 - 14	2.36	1.52	0.71	1.31
1	BH8-61/PH	H8-63/PH	SH8-63/PH	1 - 11 1/2	2.85	1.88	0.97	1.63

* Kubota Interchange

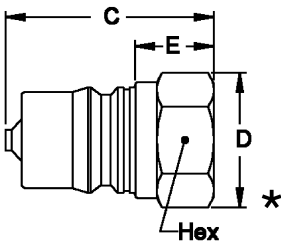

RATED PRESSURE & FLOW CAPACITY

SERIES	BODY SIZE (IN.)	BRASS		STEEL		STAINLESS STEEL	
		PSI	BAR	PSI	BAR	PSI	BAR
1-HK	1/8	3,000	207	4,000	275	5,000	344
2-HK	1/4	2,700	186	3,700	255	3,700	255
3-HK	3/8	2,200	152	3,700	255	3,700	255
4-HKP	1/2	2,250	155	5,000	345	4,250	293
6-HKP	3/4	2,000	138	4,000	275	3,500	242
8-HKP	1	1,500	103	4,000	275	2,500	173
10-HJ	1 1/4	1,200	83	1,700	118	1,700	118
12-HK	1 1/2	1,500	104	2,200	152	2,200	152
20-HK	2 1/2	700	49	1,500	104	1,500	104

Brass series used on Carpet Cleaning Hose.

HYDRAULIC QUICK DISCONNECTS

COUPLERS & PLUGS

**HK Series - 2 Way, 12HK
1 1/2" Body**

SOCKET SPECIFICATIONS

BODY SIZE (IN.)	BRASS STANDARD RB&H#	STEEL STANDARD RB&H#	THREAD SIZE FEMALE NPTF	"A" (IN.)	"B" (IN.)	"HEX" (IN.)
1 1/2	BH12-604PH	H12-624PH	1 1/4 - 11 1/2	4.82	3.23	2.38
1 1/2	B12-60N/PH	H12-62N/PH	1 1/2 - 11 1/2	4.82	3.23	2.38

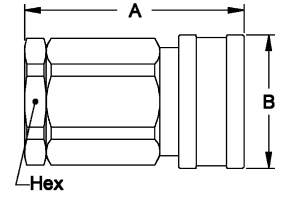

PLUG SPECIFICATIONS

BODY SIZE (IN.)	STEEL STANDARD RB&H#	THREAD SIZE FEMALE NPTF	"C" (IN.)	"D" (IN.)	"E" (IN.)	"HEX" (IN.)
1 1/2	H12-634PH	1 1/4 - 11 1/2	4.76	3.02	2.67	2.38
1 1/2	H12-63N/PH	1 1/2 - 11 1/2	4.76	3.02	2.67	2.38

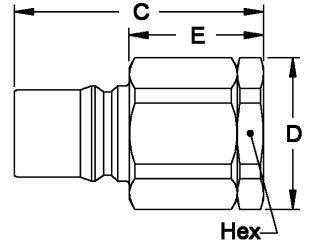

HYDRAULIC QUICK DISCONNECTS

COUPLERS

**ST Series
Straight Through**

Series ST straight-through couplings are designed for use where minimum pressure drop is required and valving is not needed. They are well suited for use on pressure wash, steam cleaning and carpet cleaning equipment, and many fluid transfer systems. Body sizes range from 1/8" to 1 1/2".



FEATURES

- Ball lock
- Manual connect, disconnect
- Smooth bore permits free flow of liquid or gas
- Zinc plated steel construction
- Male and female NPTF, BSPP and hose stem connections

STANDARD MATERIALS

- Brass or 303 stainless steel socket construction
- Stainless steel springs, balls and retaining rings
- Brass, zinc plated steel and 303 stainless steel plugs
- High impulse heat treated 416 stainless steel plugs available in 1/4" and 3/8" body sizes
- Buna-N (Nitrile) seals

OPTIONS

- Sleeve lock
- Seals: Teflon (1-ST through 8-ST), Neoprene, Viton, Buna-N and EPDM

ACCESSORIES

- Dust caps and dust plugs for a limited number of sizes

**Male End
Connections**

SOCKET

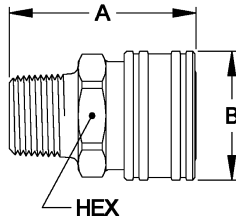

SPECIFICATIONS

BODY SIZE (IN.)	PRODUCT I.D.		THREAD SIZE NPTF	THREAD SIZE BSPP	"A" (IN.)	"B" (IN.)	"HEX" (IN.)
	BRASS RB&H #	STAINLESS RB&H #					
1/8	BST-1M/PH	SST-1M/PH	1/8 - 27	—	1.06	0.69	0.50
1/4	BST-2M/PH	SST-2M/PH	1/4 - 18	—	1.72	0.94	0.81
3/8	BST-3M/PH	SST-3M/PH	3/8 - 18	—	1.75	1.13	1.00
3/8	BST-4M/PH	SST-4M/PH	1/2 - 14	—	2.03	1.31	1.13
1/2	BST-6M/PH	SST-6M/PH	3/4 - 14	—	2.22	1.69	1.44
1/2	BST-8M/PH	—	1 - 11 1/2	—	2.53	2.00	1.75

**Female End
Connections**

SOCKET

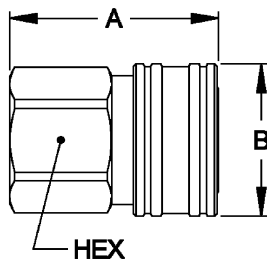

SPECIFICATIONS

BODY SIZE (IN.)	PRODUCT I.D.		THREAD SIZE NPTF	THREAD SIZE BSPP	"A" (IN.)	"B" (IN.)	"HEX" (IN.)
	BRASS RB&H #	STAINLESS RB&H #					
1/8	BST-1/PH	SST-1/PH	1/8 - 27	—	1.06	0.69	0.50
1/4	BST-2/PH	SST-2/PH	1/4 - 18	—	1.50	0.94	0.81
3/8	BST-3/PH	SST-3/PH	3/8 - 18	—	1.59	1.13	1.00
1/2	BST-4/PH	SST-4/PH	1/2 - 14	—	1.91	1.31	1.13
3/4	BST-6/PH	SST-6/PH	3/4 - 14	—	2.06	1.69	1.44
1	BST-8/PH	SST-8/PH	1 - 11 1/2	—	2.31	2.00	1.75
1 1/4	BST-10/PH	SST-10/PH	1 1/4 - 11 1/2	—	2.44	2.50	2.00
1 1/2	BST-12/PH	SST-12/PH	1 1/2 - 11 1/2	—	2.88	3.13	2.63

HYDRAULIC QUICK DISCONNECTS

PLUGS

RATED PRESSURE *

SERIES	BODY SIZE (IN.)	BRASS SOCKET/BRASS PLUG		BRASS SOCKET/STEEL PLUG		STAINLESS STEEL SOCKET & PLUG	
		PSI	BAR	PSI	BAR	PSI	BAR
1-ST	1/8	2800	193	3400	234	4200	290
2-ST	1/4	5200	359	5500	379	7500	517
3-ST	3/8	2800	193	4200	290	6300	434
4-ST	1/2	2200	152	3500	241	3600	248
6-ST	3/4	1700	117	2100	145	3000	207
8-ST	1	1300	90	2000	138	2000	138
10-ST	1 1/4	1700	117	2700	186	2200	152
12-ST	1 1/2	1400	97	2200	152	2500	172

* Pressure ratings are for sockets and plugs with threaded end connections. Pressure ratings of couplings with hose stems may be significantly lower and will depend on the type of hose and the method of clamping. Refer to hose manufacturer's end connection pressure ratings. The best way to determine suitability for an application is to run pressure testing under controlled conditions.

**ST Series
Straight Through**



SPECIFICATIONS

BODY SIZE (IN.)	PRODUCT I.D.			THREAD SIZE NPTF	THREAD SIZE BSPP	"C" (IN.)	"D" (IN.)	"HEX" (IN.)
	BRASS RB&H #	STEEL RB&H #	STAINLESS RB&H #					
1/8	BST-N1M/PH	ST-N1M/PH	SST-N1M/PH	1/8 - 27	-	1.09	0.51	0.44
1/4	BST-N2M/PH	ST-N2M/PH	SST-N2M/PH	1/4 - 18	-	1.61	0.65	0.56
3/8	BST-N3M/PH	ST-N3M/PH	SST-N3M/PH	3/8 - 18	-	1.69	0.79	0.69
1/2	BST-N4M/PH	ST-N4M/PH	SST-N4M/PH	1/2 - 14	-	2.03	1.01	0.88
3/4	BST-N6M/PH	ST-N6M/PH	SST-N6M/PH	3/4 - 14	-	2.25	1.23	1.06
1	BST-N8M/PH	ST-N8M/PH	SST-N8M/PH	1 - 11 1/2	-	2.53	1.59	1.38
1 1/2	BST-N12M/PH	-	-	1 1/2 - 11 1/2	-	3.31	2.60	2.25

**Male End
Connections**

PLUG

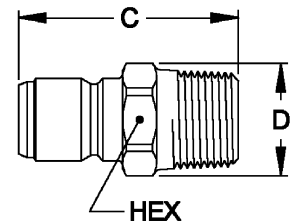

SPECIFICATIONS

BODY SIZE (IN.)	PRODUCT I.D.			THREAD SIZE NPTF	THREAD SIZE BSPP	"C" (IN.)	"D" (IN.)	"HEX" (IN.)
	BRASS RB&H #	STEEL RB&H #	STAINLESS RB&H #					
1/8	BST-N1/PH	ST-N1/PH	-	1/8 - 27	-	1.00	0.58	0.50
1/4	BST-N2/PH	ST-N2/PH	SST-N2/PH	1/4 - 18	-	1.50	0.79	0.69
3/8	BST-N3/PH	ST-N3/PH	SST-N3/PH	3/8 - 18	-	1.63	0.94	0.81
1/2	BST-N4/PH	ST-N4/PH	SST-N4/PH	1/2 - 14	-	1.94	1.15	1.00
3/4	BST-N6/PH	ST-N6/PH	SST-N6/PH	3/4 - 14	-	2.06	1.37	1.19
1	BST-N8/PH	ST-N8/PH	SST-N8/PH	1 - 11 1/2	-	2.21	1.80	1.56
1 1/4	BST-N10/PH	-	-	1 1/4 - 11 1/2	-	2.34	2.31	2.00
1 1/2	BST-N12/PH	-	-	1 1/2 - 11 1/2	-	2.88	2.60	2.25

**Female End
Connections**

PLUG

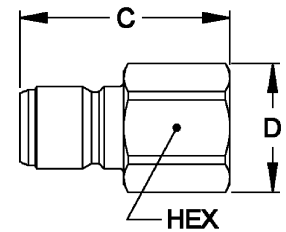

HYDRAULIC QUICK DISCONNECTS

COUPLERS & PLUGS

HA Series



FEATURES

- Ball lock
- Manual connect, disconnect
- Slim profile
- Zinc plated steel construction
- NPTF and BSPP end connections
- Available push-to-connect socket designed for bulkhead mounting (1/2" body size only)
- Interchanges with Aeroquip 5600 & Parker 6600

STANDARD MATERIALS

- Zinc-plated steel construction
- Stainless steel springs, balls and retaining rings
- Buna-N (Nitrile) seals

ACCESSORIES

- Dust caps and dust plugs.

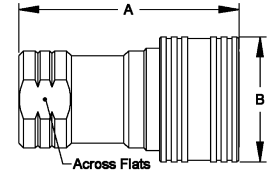

The Series HA 15000 is a general purpose hydraulic and fluid transfer coupling that conforms to the dimensional requirements of ISO 7241-1 Series A. Body sizes are 1/4", 3/8", 1/2", 3/4", and 1".

RATED PRESSURE

BODY SIZE (IN.)	PSI	BAR
1/4	4568	315
3/8	4568	315
1/2	3625	250
3/4	3625	250
1	2900	200

SOCKET SPECIFICATIONS

BODY SIZE (IN.)	STEEL RB&H #	THREAD SIZE FEMALE NPTF	THREAD SIZE FEMALE BSPP	"A" (IN.)	"B" (IN.)	"ACROSS FLATS" (IN.)
1/4	2-I-16	1/4 - 18	-	1.89	0.98	0.75
1/4	2-I-16BS	-	1/4 - 19	1.89	0.98	0.75
3/8	3-I-21	3/8 - 18	-	2.21	1.18	0.91
3/8	3-I-21BS	-	3/8 - 19	2.21	1.18	0.91
1/2	4-I-26	1/2 - 14	-	2.64	1.49	1.06
1/2	4-I-26BS	-	1/2 - 14	2.64	1.49	1.06
3/4	6-I-31	3/4 - 14	-	3.25	1.88	1.38
3/4	6-I-31BS	-	3/4 - 14	3.25	1.88	1.38
1	8-I-36	1 - 11 1/2	-	3.86	2.08	1.62
1	8-I-36BS	-	1 - 11	3.86	2.08	1.62

This system allows automatic connection and disconnection simply by pushing the plug into or pulling it out of the socket body. Pulling on the hose moves the socket body forward relative to the bulkhead mounted double-acting sleeve, and the plug is released without damage to the hose.

Sleeve dimensions for bulkhead mounting are shown at left.

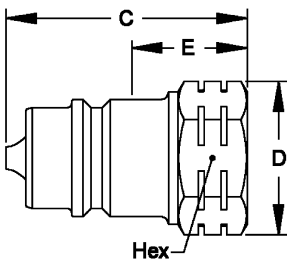

PLUG SPECIFICATIONS

BODY SIZE (IN.)	STEEL RB&H #	THREAD SIZE FEMALE NPTF	THREAD SIZE FEMALE BSPP	"C" (IN.)	"D" (IN.)	"E" (IN.)	"HEX" (IN.)
1/4	2-A-16	1/4 - 18	-	1.41	0.86	0.80	0.75
1/4	2-A-16BS	-	1/4 - 19	1.41	0.86	0.80	0.75
3/8	3-A-21	3/8 - 18	-	1.63	1.04	0.79	0.91
3/8	3-A21BS	-	3/8 - 19	1.63	1.04	0.79	0.91
1/2	4-A-26	1/2 - 14	-	1.92	1.22	0.92	1.06
1/2	4-A-26BS	-	1/2 - 14	1.92	1.22	0.92	1.06
3/4	6-A-31	3/4 - 14	-	2.42	1.58	1.09	1.38
3/4	6-A-31BS	-	3/4 - 14	2.42	1.58	1.09	1.38
1	8-A-36	1 - 11 1/2	-	2.83	1.85	1.19	1.62
1	8-A-36BS	-	1 - 11	2.83	1.85	1.19	1.62

HYDRAULIC QUICK DISCONNECTS

COUPLERS & PLUGS

FEATURES

- Ball lock
- Push-to-connect
- 3/8" and 1/2" couplings meet HTMA (Hydraulic Tool Manufacturers Association) dimensional standards
- Minimal fluid loss when disconnecting
- Minimal air inclusion when connecting
- NPTF and BSPP threads available
- Standard sleeve lock
- 3,000 PSI, 50 GPM

STANDARD MATERIALS

- Zinc-plated steel construction
- Stainless steel springs and balls
- Buna-N (Nitrile)seals

ACCESSORIES

- Dust caps

USED ON

- Hydraulic tools in aerial bucket trucks.
- Construction, railway, & mining equipment. 3,000 PSI, 50 GPM

FF (Flat Face) Series - 2 Way

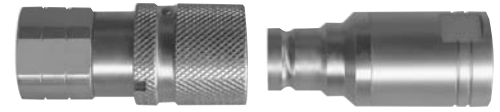

The Series QA 29000 is a flat face dry break or minimum spill hydraulic coupling. Body sizes are 3/8" and 1".

SOCKET SPECIFICATIONS						
BODY SIZE (IN.)	STEEL RB&H #	THREAD SIZE FEMALE NPTF	THREAD SIZE FEMALE BSPP	"A" (IN.)	"B" (IN.)	"HEX" (IN.)
3/8	FF-371-6FP/PH	3/8 - 18	-	2.81	1.26	1.06
3/8	FF-371-6FB/PH	-	3/8 - 19	2.81	1.26	1.06
3/8	FF-371-8FP/PH	1/2 - 14	-	2.81	1.26	1.06
3/4	FF-751-12FP/PH	3/4 - 14	-	3.11	1.50	1.38

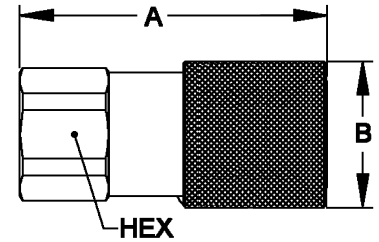

BODY SIZE (IN.)	SOCKET		PLUG	
	PSI	BAR	PSI	BAR
3/8	2,900	200	5,075	350
3/4	2,175	150	4,350	300

RATED PRESSURE

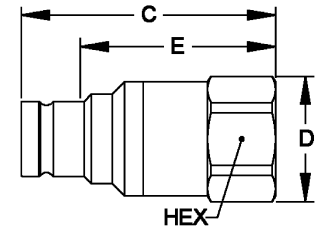

SOCKET SPECIFICATIONS						
BODY SIZE (IN.)	STEEL RB&H #	THREAD	SIZE	"A" (IN.)	"B" (IN.)	"HEX" (IN.)
1/2	FE-501-8FP	1/2 - 14	NPSF	2.65	1.58	1.38
1/2	FE-501-12FO	1 1/16 - 12	UNF	3.10	1.58	1.38
5/8	FE-621-12FO	1 1/16 - 12	UNF	3.67	1.74	1.62

FE Series - 2 Way

USED ON

- Skid Steer Loaders

FEATURES

- 40 GPM
- ISO 16028
- 1/2" = 3,000 PSI
- 5/8" = 3,625 PSI
- Steel
- Ball Lock
- -40° to +250°

PLUG SPECIFICATIONS							
BODY SIZE (IN.)	STEEL RB&H #	THREAD	SIZE	"C" (IN.)	"D" (IN.)	"E" (IN.)	"HEX" (IN.)
1/2	FE-502-8FP	1/2 - 14	NPSF	2.77	1.38	1.96	1.25
1/2	FE-502-12FO	1 1/16 - 12	UNF	3.05	1.50	2.20	1.38
5/8	FE-622-12FO	1 1/16 - 12	UNF	3.40	1.65	2.60	1.50

HYDRAULIC QUICK DISCONNECTS

COUPLERS & PLUGS

FEM Series - 2 Way

USED IN MARKETS:

- Skid Steer Loaders
- Construction
- Agriculture
- Utility

FEATURES:

- 40 GPM
- ISO 16028
- 3/8" - 3/4" = 3,625 PSI
- 1" = 2,900 PSI
- Nitrile Seal
- Sleeve Lock
- Steel Body

SOCKET SPECIFICATIONS

BODY SIZE (IN.)	STEEL RB&H #	THREAD	SIZE	"A" (IN.)	"B" (IN.)	"HEX" (IN.)
1/2	FEM-501-8FP-NL	1/2 - 14	NPSF FP	3.04	1.19	1.06
1/2	FEM-501-10FO-NL	7/8 - 14	UNF ORB	3.04	1.58	1.24
1/2	FEM-501-12FO-NL	1 1/16 - 12	UNF ORB	3.24	1.58	1.38

PLUG SPECIFICATIONS

BODY SIZE (IN.)	STEEL RB&H #	THREAD	SIZE	"C" (IN.)	"D" (IN.)	"E" (IN.)	"HEX" (IN.)
1/2	FEM-502-8FP	1/2 - 14	NPSF	2.85	1.50	2.15	1.38
1/2	FEM-502-10FO	7/8 - 14	UNF	2.85	1.50	2.15	1.38
1/2	FEM-502-12FO	1 1/16 - 12	UNF	3.05	1.50	2.35	1.38

Series 96 Wing Nut



FEATURES

- Non-spill double shut-off with minimum air inclusion
- Connect/disconnect under pressure
- Corrosion resistant brass body
- Plugs can be bulkhead mounted
- Interchanges with other manufacturers' couplings
- Interchanges with Aeroquip 5100 Series

STANDARD MATERIALS

- Brass body (socket & plug)
- Zinc-plated steel wing nut (socket)
- Stainless steel springs
- Buna-N (Nitrile) seals

ACCESSORIES

- Dust caps and dust plugs
- Bulkhead mounting flanges

The Series 96 coupling is a heavy-duty wing nut coupling designed for use in hydraulic lines where dry break and minimum air inclusion are required. It is ideal for hydraulic dump trucks, oil field equipment, spreading equipment and applications requiring the ability to connect and/or disconnect under pressure. Body sizes are 3/4", 1" and 1 1/4".

RATED PRESSURE

BODY SERIES (IN.)	PSI	BAR
3/4	3,000	207
1	3,000	207
1 1/4	3,750	190
1 1/2	2,500	180

BULKHEAD MOUNTING FLANGES

BODY SIZE (IN.)	RB&H #	DIA. BOLT HOLE "A" (IN.)	DIA. BOLT CIRCLE "B" (IN.)
3/4	78F-12	0.201	2.13
1	7AF-16	0.201	2.38
1 1/4	7AF-20	0.201	2.63
1 1/2	7AF-24	0.201	2.98

SOCKET SPECIFICATIONS

BODY SIZE (IN.)	RB&H #	THREAD SIZE NPTF	"A" (IN.)	"B" (IN.)	"ACROSS FLATS" (IN.)
3/4	B78C12-12F	3/4 - 14	3.09	4.06	1.15
1	B78C16-16F	1 - 11 1/2	3.78	4.45	1.44
1 1/4	B78C20-20F	1/4 - 11 1/2	3.97	5.20	1.78
1 1/2	B78C24-24F	1 1/2 - 11 1/2	4.16	5.95	2.12

PLUG SPECIFICATIONS

BODY SIZE (IN.)	RB&H #	THREAD SIZE NPTF	"A" (IN.)	"B" (IN.)	"ACROSS FLATS" (IN.)
3/4	B78N12-12F	3/4 - 14	3.10	1.78	1.31
1	B78N16-16F	1 - 11 1/2	3.55	2.00	1.56
1 1/4	B78N20-20F	1/4 - 11 1/2	3.71	2.38	1.88
1 1/2	B78N-24-24F	1 1/2 - 11 1/2	3.87	2.76	2.20

HYDRAULIC QUICK DISCONNECTS

COUPLERS & PLUGS

SPECIFICATIONS

RB&H #	THREAD SIZE (IN.)	RATED PRESSURE (PSI)	DESCRIPTION
5060-4	1/2 NPTF	3,000	John Deere Male Tip
5060-15	3/4 O-Ring Boss	3,000	John Deere Male Tip

SPECIFICATIONS

RB&H #	THREAD SIZE (IN.)	RATED PRESSURE (PSI)	DESCRIPTION
5070-4	1/2 NPTF	3,000	I.H. Male Tip
5070-16	7/8 O-Ring Boss	3,000	I.H. Male Tip

SPECIFICATIONS

RB&H #	THREAD SIZE (IN.)	RATED PRESSURE (PSI)	DESCRIPTION
8010-4P*	1/2 NPTF	3,000	ISO
8010-4	1/2 NPTF	3,000	ISO
8010-15P*	3/4-16 O-Ring Boss	3,000	ISO
8010-15	3/4-16 O-Ring Boss	3,000	ISO
8010-16	7/8-14 O-Ring Boss	3,000	ISO

* P- with poppet

Tips



SPECIFICATIONS

THREAD SIZE (IN.)	PRODUCT I.D.		
	SOCKET RB&H #	PLUG RB&H #	PIONEER RB&H #
1/4 Female Pipe	4050-2	4010-2	4000-2
3/8 Female Pipe	4050-3	4010-3	4000-3
1/2 Female Pipe	4050-4	8010-4	4000-4
3/4 - 16 Female Boss	4050-15	8010-15	4000-15
7/8 - 14 Female Boss	4050-16	8010-16	4000-16
3/4 Female Pipe	4050-5	8010-5	4000-5
3/4 Female Pipe	4150-5	4110-5	4100-5
1 Female Pipe	4050-6P	4010-6P	4000-6P

FEATURES

- Poppet valves are available to prevent uncoupled leakage.
- Ball valves available for rugged dependability in heavy-duty hydraulic applications, within rated working pressures.
- Critical parts are induction hardened for durability.
- Dependable ball-locking mechanism holds the mating halves together and reduces hose twisting.
- Couplers and nipples are precision machined from solid bar stock.

APPLICATIONS

The 4000 Series brings to the industry a proven design for use on agricultural machinery, oil tools, steel mill machinery, and other demanding hydraulic applications.

4000 Series
STANDARD ONE WAY SLEEVE



DESIGNED FOR: Connects when system is not operating and when it has been relieved.
PRESSURE RATING: 3,000 psi.

DESIGNED FOR: Threaded sleeve locking mechanism designed for extreme high pressure applications.

PRESSURE RATING: 10,000 psi.

SPECIFICATIONS

THREAD SIZE (IN.)	PRODUCT I.D.		PRODUCT I.D. (SET)
	SOCKET RB&H #	PLUG RB&H #	PIONEER #
1/4 Male Pipe	3050-2	3010-2	3000-2
3/8 Male Pipe	3050-3	3010-3	3000-3

3000 Series
HIGH PRESSURE COUPLER
SCREW TOGETHER TYPE



HYDRAULIC QUICK DISCONNECTS

COUPLERS & PLUGS

4200 Series

TWO WAY SLEEVE COUPLER



DESIGNED FOR: Same features as the 4000 series, but with a double acting sleeve for one handed operation.

PRESSURE RATING: 3,000 psi.

SPECIFICATIONS

THREAD SIZE (IN.)	PRODUCT I.D.		
	SOCKET RB&H #	PLUG RB&H #	PIONEER RB&H #
¼ Female Pipe	S45-2	S41-2	-
½ Female Pipe	4250-4	8010-4	4200-4
¾ - 16 O-Ring Boss	S45-15	S71-15	-
¾ - 16 O-Ring Boss	S45-15P	S71-15P	-
¾ Female Pipe	S45-6	S41-6	-

FEATURES

- Double acting sleeve for one handed operation when coupler is clamp or bulkhead mounted.
- Poppet valves are available to prevent uncoupled leakage.
- Ball valves available for rugged dependability in heavy-duty hydraulic applications, within rated working pressures
- Critical parts are induction hardened for durability.
- Dependable ball-locking mechanism holds the mating halves together and reduces hose twisting.
- Couplers and nipples are precision machined from solid bar stock.

APPLICATIONS

The 4200 Series brings to the industry a proven design for use on agricultural machinery and other demanding hydraulic applications.

8200 Series

**FULL PRESSURE COUPLER
TWO WAY SLEEVE**



DESIGNED FOR: Double acting sleeve permits easy, one handed connection. Permits connection of the female body to the male tip while either or both are under pressure.

PRESSURE RATING: 3,000 psi.

SPECIFICATIONS

THREAD SIZE (IN.)	PRODUCT I.D.		
	SOCKET RB&H #	PLUG RB&H #	(SET) PIONEER RB&H #
½ Female Pipe	8250-4	8010-4	8200-4
¾ - 16 O-Ring Boss	8250-15	8010-15	8200-15
¾ - 14 O-Ring Boss	8250-16	8010-16	8200-16

FEATURES

- Unique valve design permits connection while either or both the coupler and nipple are under pressure.
- Double acting sleeve for one handed operation when coupler is clamp or bulkhead mounted.
- Critical parts are induction hardened for durability.
- Dependable ball-locking mechanism holds the mating halves together and reduces hose twisting.
- Couplers and nipples are precision machined from solid bar stock.

APPLICATIONS

The 8200 Series brings to the industry a proven design for use on agricultural machinery, oil tools, steel mill machinery, and other demanding hydraulic applications.