

Valves

ROYAL BRASS AND HOSE

ITEM	PAGE #
Drain & Shut-Off Valves	
3 & 4 Way Tank Valves.....	448
Truck Shut-Offs	448
Hose Barb to Male Pipe (90°) Truck Valve	448
Female NPTF to Male Pipe Truck Valve	448
Compression Straightway	448
Double Male Pipe Shut-Off	448
Double Female Pipe Shut-Off	449
Male and Female Pipe Shut-Off	449
Marine Type Male and Female Pipe	449
Multi-Purpose Air Vent	449
SAE Flare to Male Pipe Truck Valve	449
SAE Flare to Male Pipe Truck Valve Heavy Duty	449
Air Tank Drain Valve 5' Cable	449
Draincock 150 psi	450
Double Male Pipe.....	450
Male and Female Pipe	450
Double Female Pipe.....	450
Double Compression	450
For Water Heaters Steel	450
Internal Seat Heavy Duty Type	451
External Seat	451
Internal Seat	451
Internal Seat	451
External Seat	451
Angle Bib Drain	451
Ground Plug Drain	452
Compression Straightway	452
Double Compression	452
Compression Angle	452
SAE Angle	452
Industrial Valves	
Standard Gate Valve Bronze	453
Check Valves (Swing)	453
Standard Ball Valves (Brass)	453
High Pressure Needle Valves.....	453
2-Piece Steel Ball Valve	453
Valve Display	
Air, Water, Gasoline/Diesel, Oil, Ag. Chemicals	454

VALVES

DRAIN & SHUT-OFF

Drain and Shut-Off Valves

USED WITH:

- Copper, aluminum, steel, plastic tubing & rubber hose where applicable

3 & 4 Way Tank Valves

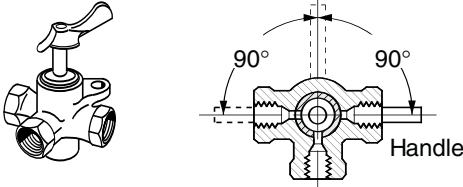

SPECIFICATIONS			
RB&H #	FEMALE PIPE (IN.)	STEM (IN.)	STEM TYPE
6707 (4 Way)	3/8	1.37	Short
6708 (4 Way)	3/8	2.37	Long
6709 (3 Way)	3/8	1.37	Short
6747 (4 Way)	1/4	1.37	Short
6748 (4 Way)	1/4	2.37	Long
6749 (3 Way)	1/4	1.37	Short

Female NPTF to Male Pipe Truck Valve



SPECIFICATIONS		
RB&H #	FEMALE PIPE (1) (IN.)	MALE PIPE (2) (IN.)
R17PHDX6X6	3/8	3/8
R17PHDX6X8	3/8	1/2
R17PHDX8X8	1/2	1/2

Truck Shut-Offs

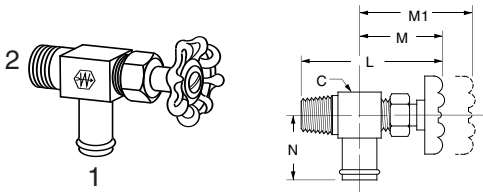

SPECIFICATIONS							
RB&H #	HOSE I.D. (1) (IN.)	MALE PIPE (2) (IN.)	"C" SQUARE (IN.)	"L" (IN.)	"M" (IN.)	"M1" (IN.)	"N" (IN.)
1422	3/8	3/8	3/4	2.93	1.78	2.25	1.12
1423	5/8	3/8	13/16	2.93	1.81	2.25	1.35
1433	3/4	3/8	15/16	3.00	1.81	2.25	1.35
1451	3/4	3/4	15/16	3.12	1.93	2.25	1.35

Compression Straightway

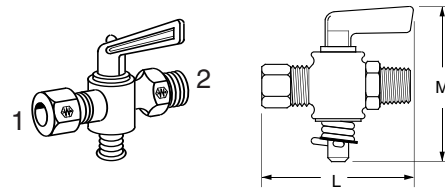

SPECIFICATIONS				
RB&H #	TUBE O.D. (1) (IN.)	MALE PIPE (2) (IN.)	"L" (IN.)	"M" (IN.)
A694	1/4	1/8	2.19	1.88
A664	5/16	1/8	2.19	1.88
A6754	1/4	1/4	2.19	1.88
A6764	3/8	1/4	2.38	1.88

Hose Barb to Male Pipe (90°) Truck Valve

SPECIFICATIONS		
RB&H #	HOSE I.D. (1) (IN.)	MALE PIPE (2) (IN.)
R5HD90X10X8	5/8	1/2
R5HD90X12X8	3/4	1/2

Double Male Pipe Shut-Off



SPECIFICATIONS	
RB&H #	MALE PIPE (IN.)
R15BX2	1/8
R15BX4	1/4
R15BX6	3/8

VALVES

DRAIN & SHUT-OFF

Double Female Pipe Shut-Off

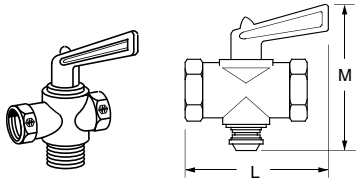

SPECIFICATIONS

RB&H #	FEMALE PIPE (IN.)	"L" (IN.)	"M" (IN.)
6804	1/8	1.46	1.88
6809	1/4	1.70	1.88
R16BX6	3/8	-	-

Multi-Purpose Air Vent

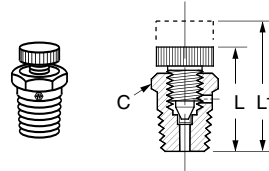

SPECIFICATIONS

RB&H #	MALE PIPE (IN.)	"C" HEX (IN.)	"L" (IN.)	"L1" (IN.)
705	1/8	13/32	.78	.88

Male and Female Pipe Shut-Off

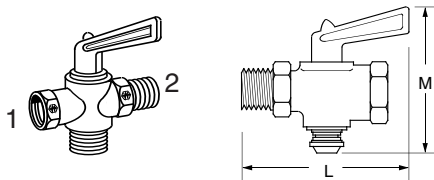

SPECIFICATIONS

RB&H #	FEMALE PIPE (1) (IN.)	MALE PIPE (2) (IN.)	"L" (IN.)	"M" (IN.)
6824	1/8	1/8	2.00	1.88
6829	1/4	1/4	2.12	1.88
R14BX6	3/8	3/8	-	-

SAE Flare to Male Pipe Truck Valve



SPECIFICATIONS

RB&H #	TUBE O.D. (IN.)	MALE PIPE (IN.)
K19X8X6	1/2	3/8
K19X8X8	1/2	1/2
K19X10X8	5/8	1/2

Marine Type Male and Female Pipe

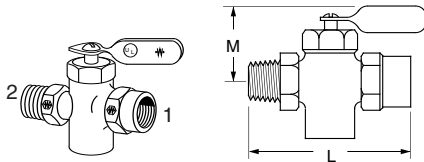

SPECIFICATIONS

RB&H #	FEMALE PIPE (1) (IN.)	MALE PIPE (2) (IN.)	"L" (IN.)	"M" (IN.)
6828	1/4	1/4	2.22	1.97

SAE Flare to Male Pipe Truck Valve
HEAVY DUTY



SPECIFICATIONS

RB&H #	TUBE O.D. (IN.)	MALE PIPE (IN.)
K49X10X8	5/8	1/2

Air Tank Drain Valve
5' CABLE

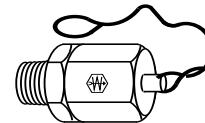

SPECIFICATIONS

RB&H #	MALE PIPE (IN.)
1421	1/4

NOTE: Pull cable sideways

VALVES

DRAIN & SHUT-OFF

Draincock
150 PSI

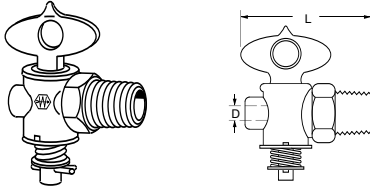

SPECIFICATIONS

RB&H #	MALE PIPE (IN.)	"D" (IN.)	"L" (IN.)
W15310	1/4	.188	1.56

Double Female Pipe

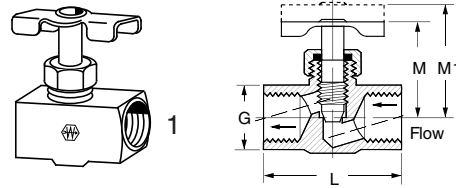

SPECIFICATIONS

RB&H #	FEMALE PIPE (1) (IN.)	"L" (IN.)	"M" (IN.)	"M1" (IN.)	"G" (IN.)
6800	1/8	1.12	0.88	1.03	.50
6805	1/4	1.62	1.11	1.26	.69

Double Male Pipe

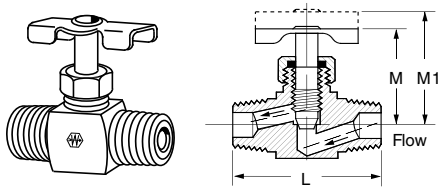

SPECIFICATIONS

RB&H #	MALE PIPE (IN.)	"L" (IN.)	"M" (IN.)	"M1" (IN.)
6810	1/8	1.38	0.66	0.80
6815	1/4	1.62	1.08	1.23

Double Compression

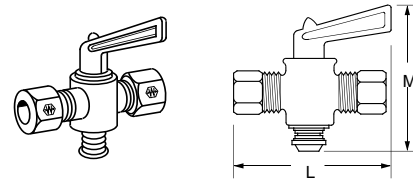

SPECIFICATIONS

RB&H #	TUBE O.D. (IN.)	"L" (IN.)	"L" (IN.)
A6769	1/4	2.12	1.88
A6774	5/16	2.19	1.88
A6779	3/8	2.25	1.88

Male and Female Pipe

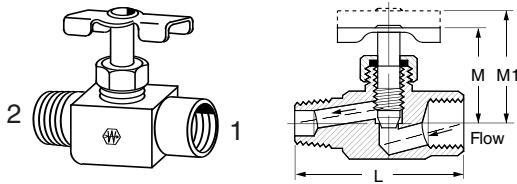

SPECIFICATIONS

RB&H #	FEMALE PIPE (1) (IN.)	MALE PIPE (2) (IN.)	"L" (IN.)	"M" (IN.)	"M1" (IN.)
6820	1/8	1/8	1.18	0.88	1.03
6825	1/4	1/4	1.88	1.09	1.24

For Water Heaters

STEEL

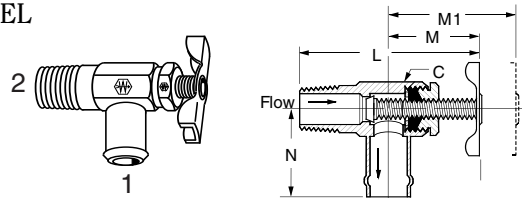

SPECIFICATIONS

RB&H #	HOSE I.D. (1) (IN.)	MALE PIPE (2) (IN.)	"C" (IN.)	"L" (IN.)	"M" (IN.)	"M1" (IN.)	"N" (IN.)
R590X10X6 (211280A)	5/8	3/8	1 1/16	2.32	1.10	1.47	1.19

VALVES

DRAIN & SHUT-OFF

* 150 PSI, maximum - brass bodies, steel handles

**Internal Seat
Heavy Duty Type**

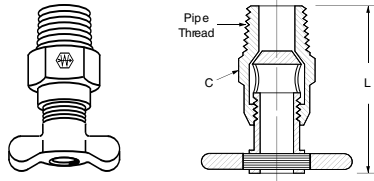

SPECIFICATIONS

RB&H #	MALE PIPE (IN.)	"C" HEX (IN.)	"L" (IN.)
1424	1/8	17/32	1.50
1425	1/4	5/8	1.79
1426	3/8	11/16	1.75

Internal Seat

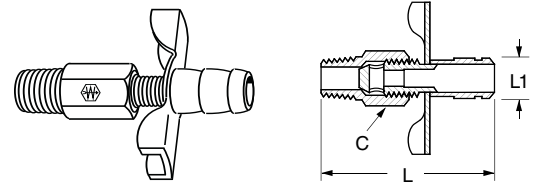

SPECIFICATIONS

RB&H #	MALE PIPE (IN.)	"C" (IN.)	"L" (IN.)	"L1" (IN.)
6783	1/8	13/32	1.63	.344

External Seat

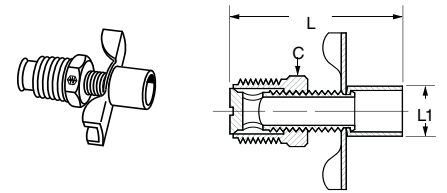

SPECIFICATIONS

RB&H #	MALE PIPE (IN.)	"C" (IN.)	"L" (IN.)	"L1" (IN.)
6788	1/4	9/16	1.56	.44

External Seat

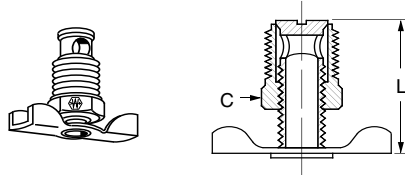

SPECIFICATIONS

RB&H #	MALE PIPE (IN.)	"C" (IN.)	"L" (IN.)	"L1" (IN.)
135	1/8	7/16	0.90	1.25
145	1/4	9/16	1.00	1.38
270	3/8	11/16	1.25	1.50
108	1/2	7/8	1.52	2.00

Angle Bib Drain

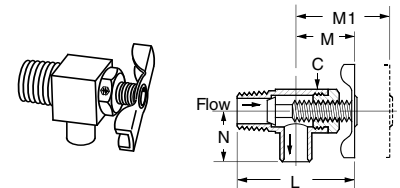

SPECIFICATIONS

RB&H #	MALE PIPE (IN.)	"C" (IN.)	"L" (IN.)	"M" (IN.)	"M1" (IN.)	"N" (IN.)
150	1/8	7/16	1.12	.57	0.95	.38
120	1/4	5/8	1.76	.94	1.50	.66

Internal Seat

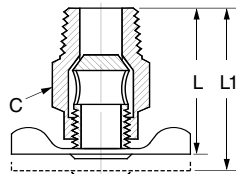

SPECIFICATIONS

RB&H #	MALE PIPE (IN.)	"C" HEX (IN.)	"L" (IN.)	"L1" (IN.)
130	1/8	17/32	1.15	1.30
140	1/4	5/8	1.32	1.50
190	1/4	9/16	1.25	1.41
230	3/8	11/16	1.34	1.50

VALVES

DRAIN & SHUT-OFF

Ground Plug Drain

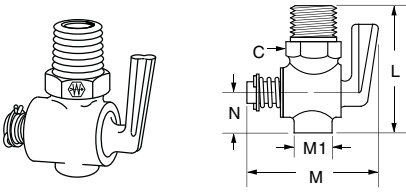

SPECIFICATIONS

RB&H #	MALE PIPE (IN.)	"C" HEX (IN.)	"L" (IN.)	"N" (IN.)	"M" (IN.)	"M1" (IN.)
6891	1/8	9/16	1.93	0.75	1.63	0.87
6892	1/4	5/8	1.62	0.75	1.75	1.03
6893	3/8	11/16	1.72	1.00	2.31	1.22

Compression Angle

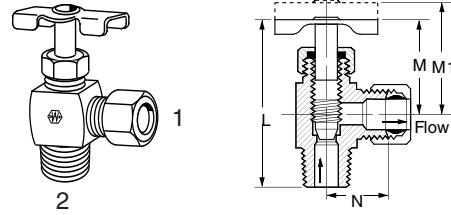

SPECIFICATIONS

RB&H #	TUBE O.D. (1) (IN.)	MALE PIPE (2) (IN.)	"L" (IN.)	"M" (IN.)	"M1" (IN.)	"N" (IN.)
A6845	3/16	1/8	1.50	.82	1.07	.50
A555	1/4	1/8	1.53	.83	1.05	.53
A655	5/16	1/8	1.56	.84	1.09	.52
A6860	3/8	1/4	1.64	.83	1.28	.78

Compression Straightway

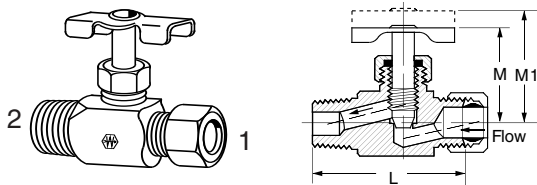

SPECIFICATIONS

RB&H #	TUBE O.D. (IN.)	MALE PIPE (IN.)	"L" (IN.)	"M" (IN.)	"M1" (IN.)
A690	1/4	1/8	1.19	.88	1.03
A660	5/16	1/8	1.18	.90	1.05

SAE Angle

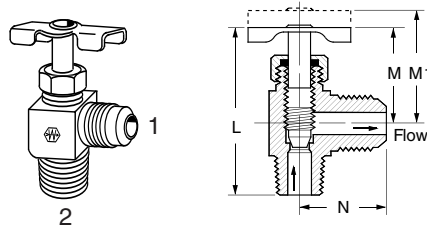

SPECIFICATIONS

RB&H #	TUBE O.D. (1) (IN.)	MALE PIPE (2) (IN.)	"L" (IN.)	"M" (IN.)	"M1" (IN.)	"N" (IN.)
320	1/4	1/8	1.54	0.86	1.07	.68
6703	5/16	1/4	1.94	1.00	1.31	.90
330	3/8	1/4	1.84	0.90	1.21	.97

Double Compression

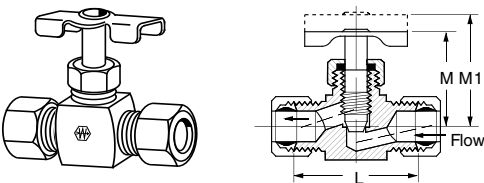

SPECIFICATIONS

RB&H #	TUBE O.D. (IN.)	"L" (IN.)	"M" (IN.)	"M1" (IN.)
A6765	1/4	1.13	0.88	1.03
A6770	5/16	1.13	0.88	1.03
A6775	3/8	1.50	1.13	1.31

VALVES

INDUSTRIAL

Industrial Valves

Standard Gate Valve

BRONZE

SPECIFICATIONS

RB&H #	FEMALE PIPE (IN.)
GATE-VALVE-1/4	1/4
GATE-VALVE-3/8	3/8
GATE-VALVE-1/2	1/2
GATE-VALVE-3/4	3/4
GATE-VALVE-1	1
GATE-VALVE-1-1/4	1 1/4
GATE-VALVE-1-1/2	1 1/2
GATE-VALVE-2	2
GATE-VALVE-2-1/2	2 1/2
GATE-VALVE-3	3
GATE-VALVE-4	4



- FEATURES:**
- 200 psi Water/Oil/Gas
 - 125 psi Steam Working Pressure

High Pressure Needle Valves

SPECIFICATIONS

RB&H #	FEMALE PIPE (IN.)
N1512	1/4
N1513	3/8
N1514	1/2



- FEATURES:**
- 10,000 psi (Max.) Water/Oil/Gas

2-Piece Steel Ball Valve

SPECIFICATIONS

RB&H #	THREAD (IN.)	STEEL
BA-160-1/4	1/4	Stainless
BA-160-2	2	Stainless
BA-170-1/4	1/4	Carbon
BA-170-1/2	1/2	Carbon
BA-170-2	2	Carbon



- FEATURES:**
- 1/4" - 1" 2,000 psi
 - 1/4" - 2" 1,500 psi

SPECIFICATIONS

RB&H #	FEMALE PIPE (IN.)
CHECK-VALVE-1/8	1/8
CHECK-VALVE-1/4	1/4
CHECK-VALVE-3/8	3/8
CHECK-VALVE-1/2	1/2

Check Valves

SWING



- FEATURES:**
- 200 psi Water/Oil/Gas
 - 125 psi Stream
 - For air, water and fuel
 - Bronze straight pattern

Standard Ball Valves

BRASS

SPECIFICATIONS

RB&H #	FEMALE PIPE (IN.)
BALL-VALVE-4	1/4
BALL-VALVE-6	3/8
BALL-VALVE-8	1/2
BALL-VALVE-12	3/4
BALL-VALVE-16	1
BALL-VALVE-20	1 1/4
BALL-VALVE-24	1 1/2
BALL-VALVE-32	2



- FEATURES:**
- 400 psi Water/Oil/Gas

VALVES

VALVE DISPLAY

Increase Sales Now

Open The Gate On Your Valve Sales

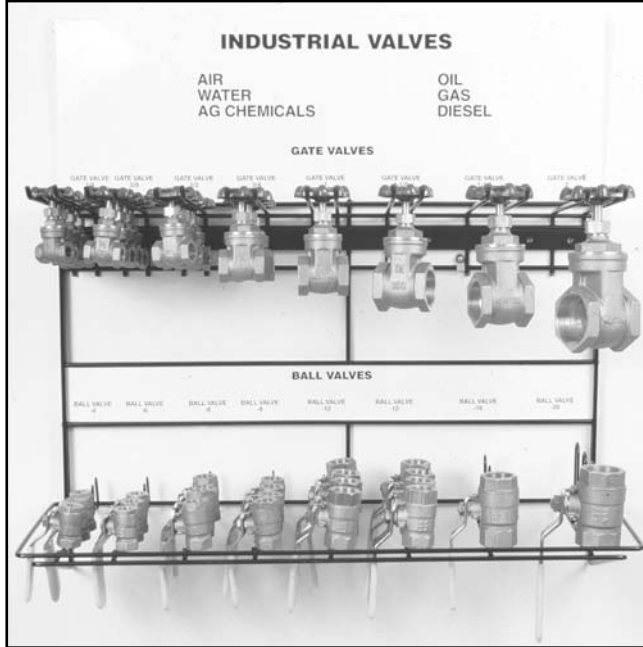

DISPLAY INCLUDES:

- Wall unit with easy-to-read header board highlighting applications
- Most popular industrial valves:
8 sizes of gate valves from 1/4" to 2"
6 sizes of ball valves from 1/4" to 1 1/4"
50 total pieces
- Labeled for easy re-ordering
- Designed for quality, appearance and long life

RB&H # VALVE-DISPLAY

Air, Water, Gasoline/Diesel, Oil, Ag. Chemicals

DISPLAY INCLUDES

RB&H #	DISPLAY QUANTITY (PCS.)	MAXIMUM CAPACITY (PCS.)
GATE-VALVE-1/4	2	7
GATE-VALVE-3/8	2	7
GATE-VALVE-1/2	2	7
GATE-VALVE-3/4	2	6
GATE-VALVE-1	1	4
GATE-VALVE-1-1/4	1	4
GATE-VALVE-1-1/2	1	3
GATE-VALVE-2	1	3
BALL-VALVE-4	2	6
BALL-VALVE-6	2	6
BALL-VALVE-8	3	12
BALL-VALVE-12	3	10
BALL-VALVE-16	1	4
BALL-VALVE-20	1	4